

Plotted By: Tuggle, Benj Sheet Set: C1307 BISCAYNE & NE 140TH Layout: L0.1 TREE INVENTORY PLAN February 10, 2025 05:23:18pm K:\NRB_DEV\RAISING CANES\1307 - North Miami Beach - Biscayne & NE 140th - North Miami Beach - FL\CAD\PlanSheets\L-TREE INV.dwg

**BISCAYNE BOULEVARD (U.S. HIGHWAY NO. 1)
(STATE ROAD NO. 5)**

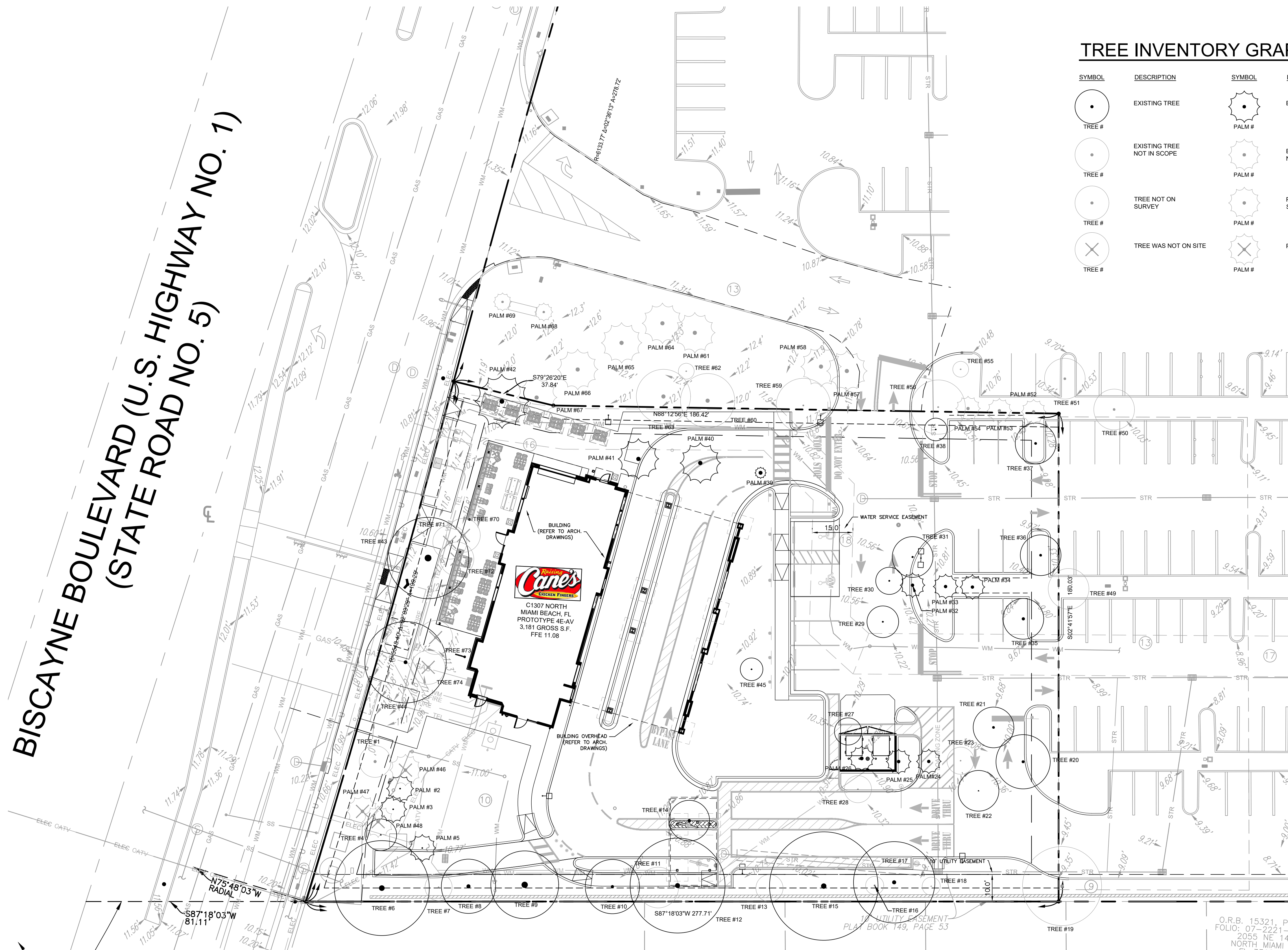

TREE INVENTORY GRAPHIC LEGEND

SYMBOL	DESCRIPTION	SYMBOL	DESCRIPTION
	EXISTING TREE		EXISTING PALM
	EXISTING TREE NOT IN SCOPE		EXISTING PALM NOT IN SCOPE
	TREE NOT ON SURVEY		PALM NOT ON SURVEY
	TREE WAS NOT ON SITE		PALM WAS NOT ON SITE



- NOTES:**
- INFORMATION UTILIZED IN PREPARATION OF TREE DISPOSITION PLANS ASCERTAINED FROM SITE OBSERVATIONS DATED 09/26/24 (TREE LOCATION, SPECIES IDENTIFICATION, AND TREE DBH), 2024 GOOGLE IMAGERY (+/- CANOPY DIAMETER).
 - REFER TO SHEET L2.0 FOR LANDSCAPE PLAN
 - NO EXISTING TREES SHALL BE REMOVED OR RELOCATED UNTIL A TREE REMOVAL PERMIT HAS BEEN ISSUED BY BROWARD COUNTY.

BENCHMARKS

ELEVATIONS ARE BASED ON NORTH GEODETIC VERTICAL DATUM OF 1929. MIAMI-DADE COUNTY BENCHMARK: S-35; ELEVATION: 11.33 FEET.

DEWATERING NOTE

THE GENERAL CONTRACTOR IS TO DEWATER THE SITE BASED ON THEIR MEANS AND METHODS FOR INSTALLATION OF UTILITIES AND UNDERGROUND WORK. ALL COSTS ASSOCIATED WITH DEWATERING SHALL BE INCLUDED IN THE BID.

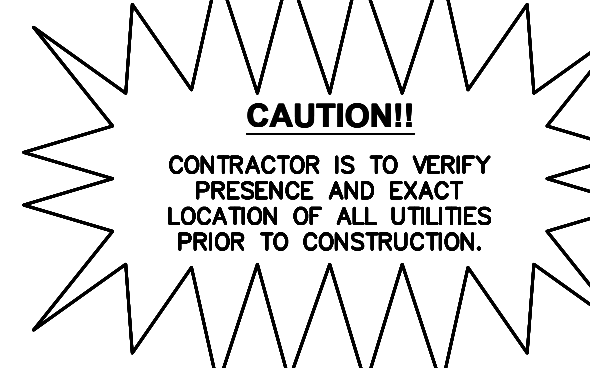

zebra
ZEBRA ARCHITECTURE, PLLC
14614 N KIERLAND BLVD, SUITE N300
SCOTTSDALE, ARIZONA 85254
PHONE: 480.912.1169 zbr.glob@zebraarch.com

PRELIMINARY:
Preliminary Documents are for design review only and not intended for bidding, negotiating, permitting, or construction purposes. They were prepared by or under the supervision of Zebra Architecture PLLC, Inc.

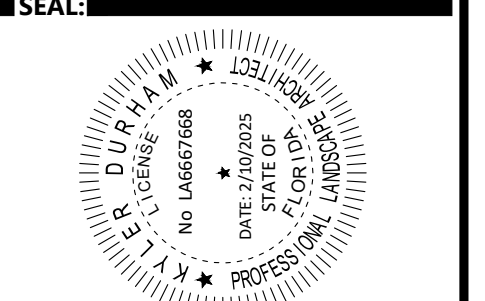

FIELD VERIFICATION:
The Contractor shall verify all figured dimensions and conditions at the project site and notify Zebra Architecture, PLLC of any dimensional errors, omissions or discrepancies before beginning or fabricating any work. Do not scale these drawings.
COPYRIGHT © 2024
Zebra Architecture, PLLC shall retain all common law, statutory and all other reserved rights. Neither the documents nor the information herein is to be reproduced, distributed, disclosed or otherwise without the written consent of Zebra Architecture, PLLC.

CONSULTANT:
Designer's Information:

Kimley»Horn
445 24TH STREET, SUITE 200, VERO BEACH, FL 32960
PHONE: 772-794-4100
WWW.KIMLEYHORN.COM
© 2024 KIMLEY-HORN AND ASSOCIATES, INC.

KIMLEY HORN Project Manager: KB

Raising Cane's
PROTOTYPE P4E-AV
SCHEME A of B
VERSION 2024-1.0

RAISING CANE'S
RESTAURANT NO.: #1307
14025 BISCAYNE BLVD.
(BISCAYNE BLVD & 143RD ST)
MIAMI, FLORIDA 33154

REV	DATE	DESCRIPTION
#	10.01.24	PRELIMINARY PROTO DEVELOPMENT
XX	XX	

DRAWN BY: BPT
CHECKED BY: KEB
ARCH. PROJECT NO.: 147793039
SHEET NAME: TREE INVENTORY PLAN
SHEET NUMBER: L0.1

SITE PLAN REVIEW

TREE DISPOSITION LIST

TREE #	COMMON NAME	BOTANICAL NAME	CANOPY (ft)	DBH (in)	HEIGHT (ft)	HEALTH CONDITION	DISPOSITION	MITIGATION
TREE 1	Black Olive	<i>Olea europaea</i>	12	11	35	Good	REMOVE	113.04
PALM 2	Alexander Palm	<i>Archontophoenix alexandrae</i>	10	4	25	Good	REMAIN	
PALM 3	Alexander Palm	<i>Archontophoenix alexandrae</i>	10	4	25	Good	REMAIN	
TREE 4	Verawood	<i>Bulnesia arborea</i>	12	4	10	Good	REMAIN	
PALM 5	Alexander Palm	<i>Archontophoenix alexandrae</i>	10	4	25	Good	RELOCATE	
TREE 6	Verawood	<i>Bulnesia arborea</i>	35	22	40	Good	REMAIN	
TREE 7	Verawood	<i>Bulnesia arborea</i>	10	4	11	Good	REMAIN	
TREE 8	Black Olive	<i>Olea europaea</i>	20	13	30	Good	REMAIN	
TREE 9	Black Olive	<i>Olea europaea</i>	25	25	35	Good	REMAIN	
TREE 10	Black Olive	<i>Olea europaea</i>	20	11	30	Good	REMOVE	314.00
TREE 11	Verawood	<i>Bulnesia arborea</i>	15	6	30	Good	REMOVE	176.63
TREE 12	Black Olive	<i>Olea europaea</i>	35	19	40	Good	SPECIMEN - REMOVE	1,923.25
TREE 13	Verawood	<i>Bulnesia arborea</i>	10	5	12	Good	REMAIN	
TREE 14	Black Olive	<i>Olea europaea</i>	15	7	25	Good	REMOVE	176.63
TREE 15	Black Olive	<i>Olea europaea</i>	40	21	50	Good	REMAIN	
TREE 16	Black Olive	<i>Olea europaea</i>	7	6	15	Good	REMAIN	
TREE 17	Black Olive	<i>Olea europaea</i>	30	15	30	Good	REMAIN	
TREE 18	Pigeon Plum	<i>Coccoloba diversifolia</i>	7	3	12	Good	REMAIN	
TREE 19	Black Olive	<i>Olea europaea</i>	25	13	25	Good	N.I.S.	
TREE 20	Live Oak	<i>Quercus virginiana</i>	20	10	25	Good	REMOVE	314.00
TREE 21	Live Oak	<i>Quercus virginiana</i>	15	8	20	Good	REMOVE	176.63
TREE 22	Live Oak	<i>Quercus virginiana</i>	15	8	20	Good	REMOVE	176.63
TREE 23	Clusia	<i>Clusia</i>	10	4	15	Good	REMOVE	78.50
PALM 24	Sabel Palm	<i>Sabal palmetto</i>	9	12	35	Good	REMOVE	63.59
PALM 25	Sabel Palm	<i>Sabal palmetto</i>	9	12	40	Good	REMOVE	63.59
PALM 26	Sabel Palm	<i>Sabal palmetto</i>	9	14	30	Good	REMOVE	63.59
TREE 27	Live Oak	<i>Quercus virginiana</i>	10	4	15	Good	REMOVE	78.50
TREE 28	Live Oak	<i>Quercus virginiana</i>	10	4	15	Good	REMOVE	78.50
TREE 29	Yaupon Holly	<i>Ilex vomitoria</i>	12	5	15	Good	REMOVE	113.04
TREE 30	Clusia	<i>Clusia</i>	10	5	12	Good	REMOVE	78.50
TREE 31	Yaupon Holly	<i>Ilex vomitoria</i>	15	6	15	Good	REMOVE	176.63
PALM 32	Sabel Palm	<i>Sabal palmetto</i>	9	12	35	Good	REMOVE	63.59
PALM 33	Sabel Palm	<i>Sabal palmetto</i>	9	12	40	Good	REMAIN	
PALM 34	Sabel Palm	<i>Sabal palmetto</i>	9	12	35	Good	REMAIN	
TREE 35	Live Oak	<i>Quercus virginiana</i>	15	7	20	Poor	REMOVE	176.63
TREE 36	Live Oak	<i>Quercus virginiana</i>	15	9	20	Good	REMAIN	
TREE 37	Live Oak	<i>Quercus virginiana</i>	15	9	20	Good	REMAIN	
TREE 38	Magnolia	<i>Magnolia</i>	8	4	13	Good	REMAIN	
PALM 39	Royal Palm	<i>Roystonea regia</i>	4	16	40	Poor	REMOVE	12.56
PALM 40	Royal Palm	<i>Roystonea regia</i>	15	16	40	Good	REMOVE	176.63
PALM 41	Royal Palm	<i>Roystonea regia</i>	15	16	40	Good	REMOVE	176.63
PALM 42	Royal Palm	<i>Roystonea regia</i>	20	18	50	Good	SPECIMEN - REMOVE	628.00
TREE 43	Black Olive	<i>Olea europaea</i>	30	27	40	Good	REMAIN	
TREE 44	Black Olive	<i>Olea europaea</i>	30	14	35	Good	REMOVE	706.50
TREE 45	Magnolia	<i>Magnolia</i>	8	4	13	Good	REMAIN	
TREE 49	Live Oak	<i>Quercus virginiana</i>	15	9	20	Good	N.I.S.	
TREE 50	Live Oak	<i>Quercus virginiana</i>	15	9	20	Good	N.I.S.	
TREE 51	Live Oak	<i>Quercus virginiana</i>	15	9	20	Good	N.I.S.	
PALM 52	Sabel Palm	<i>Sabal palmetto</i>	9	12	25	Good	N.I.S.	
PALM 53	Sabel Palm	<i>Sabal palmetto</i>	9	12	40	Good	N.I.S.	
PALM 54	Sabel Palm	<i>Sabal palmetto</i>	9	12	35	Good	N.I.S.	
TREE 55	Live Oak	<i>Quercus virginiana</i>	6	4	12	Good	N.I.S.	
TREE 56	Clusia	<i>Clusia</i>	20	5	12	Good	N.I.S.	
PALM 57	Royal Palm	<i>Roystonea regia</i>	15	16	40	Good	N.I.S. - REMOVE	176.63
PALM 58	Royal Palm	<i>Roystonea regia</i>	15	16	40	Good	N.I.S.	
TREE 59	Clusia	<i>Clusia</i>	20	5	12	Good	N.I.S.	
TREE 60	Live Oak	<i>Quercus virginiana</i>	20	16	35	Good	N.I.S.	
PALM 61	Royal Palm	<i>Roystonea regia</i>	15	16	40	Good	N.I.S.	
TREE 62	Live Oak	<i>Quercus virginiana</i>	6	3	12	Good	N.I.S.	
TREE 63	Live Oak	<i>Quercus virginiana</i>	20	16	35	Good	N.I.S.	
PALM 64	Royal Palm	<i>Roystonea regia</i>	15	16	40	Good	N.I.S.	
PALM 65	Royal Palm	<i>Roystonea regia</i>	15	16	40	Good	N.I.S.	
PALM 66	Royal Palm	<i>Roystonea regia</i>	15	16	30	Good	N.I.S.	
PALM 67	Royal Palm	<i>Roystonea regia</i>	15	16	40	Good	N.I.S. - REMOVE	176.63
PALM 68	Royal Palm	<i>Roystonea regia</i>	7	8	7	Fair	N.I.S.	
PALM 69	Royal Palm	<i>Roystonea regia</i>	7	8	7	Fair	N.I.S.	
TOTAL MITIGATION REQUIRED (SF):								6,458.98

MITIGATION CALCULATIONS

CATEGORY	QUANTITY	CANOPY CREDIT (sqft.)	CANOPY (sqft.)
Shade Tree 1 <i>Minimum 12' Overall Height</i>	14	500	7000
Shade Tree 2 <i>Minimum 8' Overall Height</i>	0	300	0
Palm Tree 1 <i>Minimum 10' Clear Trunk</i>	7	200	1400
Palm Tree 2 <i>Minimum 3' Clear Trunk</i>	6	100	600
Small Tree <i>Minimum 6' Overall Height</i>	0	200	0

Total Canopy Provided = 9,000.00

BENCHMARKS

ELEVATIONS ARE BASED ON NORTH GEODETIC VERTICAL DATUM OF 1929. MIAMI-DADE COUNTY BENCHMARK: S-35; ELEVATION: 11.33 FEET.

DEWATERING NOTE

THE GENERAL CONTRACTOR IS TO DEWATER THE SITE BASED ON THEIR MEANS AND METHODS FOR INSTALLATION OF UTILITIES AND UNDERGROUND WORK. ALL COSTS ASSOCIATED WITH DEWATERING SHALL BE INCLUDED IN THE BID.



Know what's below.
Call before you dig.

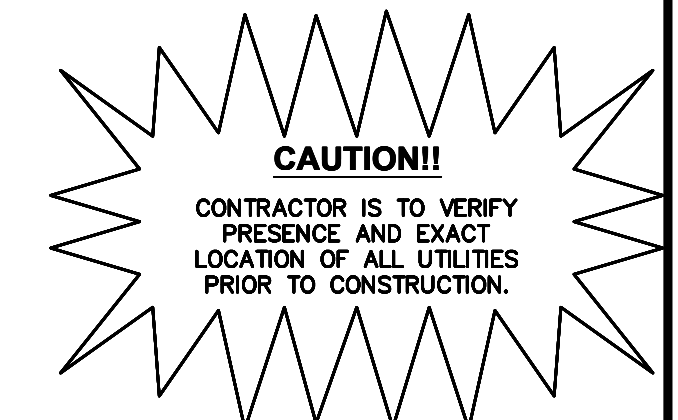

ZEBRA ARCHITECTURE, PLLC
14614 N KIERLAND BLVD, SUITE
N300
SCOTTSDALE, ARIZONA 85254
PHONE: 480.912.1169 zbr.glob@zebraarch.com

PRELIMINARY:
Preliminary Documents are for design review only and not intended for bidding, permitting, or construction purposes. They were prepared by or under the supervision of Zebra Architecture PLLC, Inc.

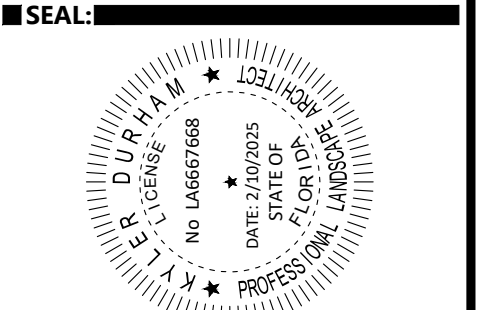

FIELD VERIFICATION:
The Contractor shall verify all figured dimensions and conditions at the project site and notify Zebra Architecture, PLLC, of any dimensional errors, omissions or discrepancies before beginning or fabricating any work. Do not scale these drawings.

COPYRIGHT © 2024
Zebra Architecture, PLLC, shall retain all common law, statutory and all other reserved rights. Neither the documents nor the information herein is to be reproduced, distributed, disclosed or otherwise without the written consent of Zebra Architecture, PLLC.

CONSULTANT:
Designer's Information:



445 24TH STREET, SUITE 200, VERO BEACH, FL 32960
PHONE: 772-794-4100
WWW.KIMLEY-HORN.COM
© 2024 KIMLEY-HORN AND ASSOCIATES, INC.

KIMLEY HORN Project Manager: KB

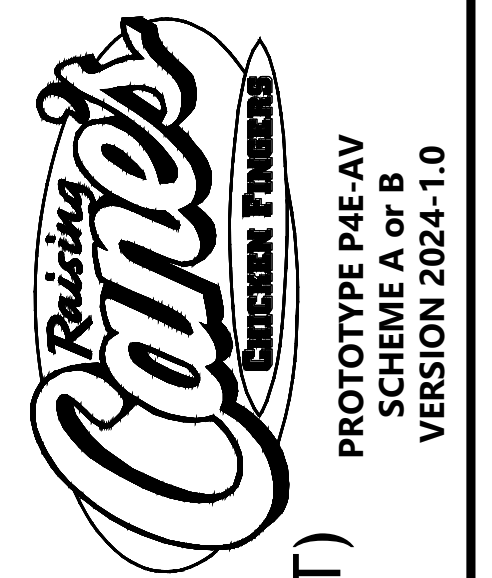

RAISING CANE'S
RESTAURANT NO.: #1307
14025 BISCAYNE BLVD.
(BISCAYNE BLVD & 143RD ST)
MIAMI, FLORIDA 33154

REV	DATE	DESCRIPTION
#	10.01.24	PRELIMINARY PROTO DEVELOPMENT
XX	XX	XX

DRAWN BY: BPT
CHECKED BY: KEB
ARCH. PROJECT NO.: 147793039
SHEET NAME: TREE INVENTORY LIST
SHEET NUMBER: L0.2

SITE PLAN REVIEW

Plotted By: Tuggle, Benj Sheet Set: C1307 BISCAYNE & NE 140TH February 10, 2025 05:23:49pm K:\WEB_DEV\Raing Cane's\C1307 - Biscayne & NE 140th - North Miami Beach, FL\CAD\PlanSheets\L1-0-TREE.dwg

**BISCAYNE BOULEVARD (U.S. HIGHWAY NO. 1)
(STATE ROAD NO. 5)**

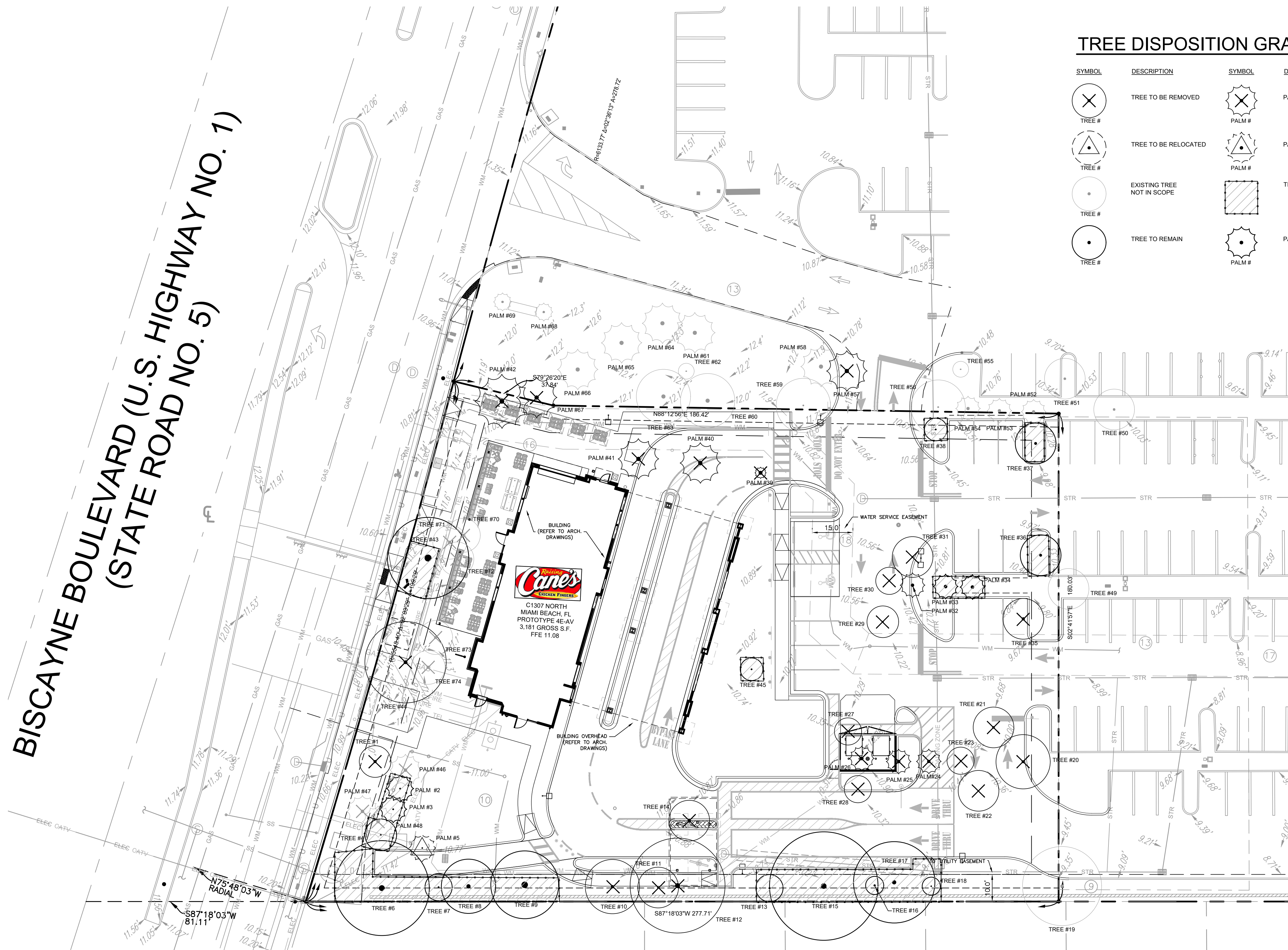

TREE DISPOSITION GRAPHIC LEGEND

SYMBOL	DESCRIPTION	SYMBOL	DESCRIPTION
	TREE TO BE REMOVED		PALM TO BE REMOVED
	TREE TO BE RELOCATED		PALM TO BE RELOCATED
	EXISTING TREE NOT IN SCOPE		TREE PROTECTION FENCE
	TREE TO REMAIN		PALM TO REMAIN



- NOTES:**
- INFORMATION UTILIZED IN PREPARATION OF TREE DISPOSITION PLANS ASCERTAINED FROM SITE OBSERVATIONS DATED 09/26/24 (TREE LOCATION, SPECIES IDENTIFICATION, AND TREE DBH), 2024 GOOGLE IMAGERY (+/- CANOPY DIAMETER).
 - REFER TO SHEET L2.0 FOR LANDSCAPE PLAN
 - NO EXISTING TREES SHALL BE REMOVED OR RELOCATED UNTIL A TREE REMOVAL PERMIT HAS BEEN ISSUED BY BROWARD COUNTY.

BENCHMARKS

ELEVATIONS ARE BASED ON NORTH GEODETIC VERTICAL DATUM OF 1929. MIAMI-DADE COUNTY BENCHMARK: S-35; ELEVATION: 11.33 FEET.

DEWATERING NOTE

THE GENERAL CONTRACTOR IS TO DEWATER THE SITE BASED ON THEIR MEANS AND METHODS FOR INSTALLATION OF UTILITIES AND UNDERGROUND WORK. ALL COSTS ASSOCIATED WITH DEWATERING SHALL BE INCLUDED IN THE BID.



zebra
ZEBRA ARCHITECTURE, PLLC
14614 N KIERLAND BLVD, SUITE N300
SCOTTSDALE, ARIZONA 85254
PHONE: 480.912.1169 zbr.glob-01

PRELIMINARY:
Preliminary Documents are for design review only and not intended for bidding, negotiating, permitting, or construction purposes. They were prepared by or under the supervision of Zebra Architecture PLLC, Inc.

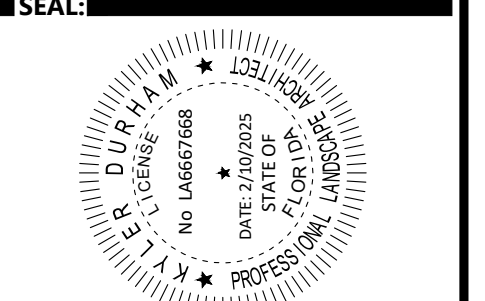

FIELD VERIFICATION:
The Contractor shall verify all figured dimensions and conditions at the project site and notify Zebra Architecture, PLLC of any dimensional errors, omissions or discrepancies before beginning or fabricating any work. Do not scale these drawings.
COPYRIGHT © 2024
Zebra Architecture, PLLC shall retain all common law, statutory and all other reserved rights. Neither the documents nor the information herein is to be reproduced, distributed, disclosed or otherwise without the written consent of Zebra Architecture, PLLC.

CONSULTANT:
Designer's Information:

Kimley»Horn
445 24TH STREET, SUITE 200, VERO BEACH, FL 32960
PHONE: 772-794-4100
WWW.KIMLEY-HORN.COM
© 2024 KIMLEY-HORN AND ASSOCIATES, INC.

KIMLEY HORN Project Manager: KB

Raising Cane's
PROTOTYPE P4E-AV
SCHEME A of B
VERSION 2024-1.0

RAISING CANE'S
RESTAURANT NO.: #1307
14025 BISCAYNE BLVD.
(BISCAYNE BLVD & 143RD ST)
MIAMI, FLORIDA 33154

REV	DATE	DESCRIPTION
1	10.01.24	PRELIMINARY PROTO DEVELOPMENT
XX	XX	

DRAWN BY: BPT
CHECKED BY: KEB
ARCH. PROJECT NO.: 147793039
SHEET NAME: TREE DISPOSITION PLAN
SHEET NUMBER: L1.0

SITE PLAN REVIEW

**BISCAYNE BOULEVARD (U.S. HIGHWAY NO. 1)
(STATE ROAD NO. 5)**



TREE INVENTORY GRAPHIC LEGEND

SYMBOL	DESCRIPTION	SYMBOL	DESCRIPTION
	EXISTING TREE		EXISTING PALM
	EXISTING TREE NOT IN SCOPE		EXISTING PALM NOT IN SCOPE
	TREE NOT ON SURVEY		PALM NOT ON SURVEY
	TREE WAS NOT ON SITE		PALM WAS NOT ON SITE



- NOTES:**
- INFORMATION UTILIZED IN PREPARATION OF TREE DISPOSITION PLANS ASCERTAINED FROM SITE OBSERVATIONS DATED 09/26/24 (TREE LOCATION, SPECIES IDENTIFICATION, AND TREE DBH), 2024 GOOGLE IMAGERY (+/- CANOPY DIAMETER).
 - REFER TO SHEET L2.0 FOR LANDSCAPE PLAN
 - NO EXISTING TREES SHALL BE REMOVED OR RELOCATED UNTIL A TREE REMOVAL PERMIT HAS BEEN ISSUED BY BROWARD COUNTY.

BENCHMARKS

ELEVATIONS ARE BASED ON NORTH GEODETIC VERTICAL DATUM OF 1929. MIAMI-DADE COUNTY BENCHMARK: S-35; ELEVATION: 11.33 FEET.

DEWATERING NOTE

THE GENERAL CONTRACTOR IS TO DEWATER THE SITE BASED ON THEIR MEANS AND METHODS FOR INSTALLATION OF UTILITIES AND UNDERGROUND WORK. ALL COSTS ASSOCIATED WITH DEWATERING SHALL BE INCLUDED IN THE BID.



Know what's below.
Call before you dig.



zebra
ZEBRA ARCHITECTURE, PLLC
14614 N KIERLAND BLVD, SUITE
N300
SCOTTSDALE, ARIZONA 85254
PHONE: 480.912.1169 zbr.glob@zebraarch.com

PRELIMINARY:
Preliminary Documents are for design review only and not intended for bidding, permitting, or construction purposes. They were prepared by or under the supervision of Zebra Architecture PLLC, Inc.

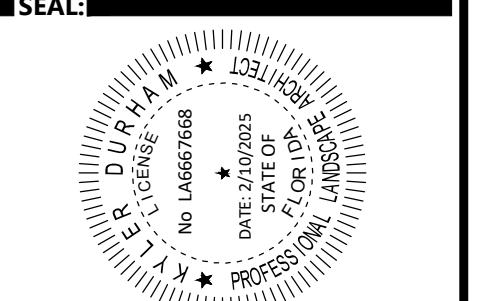

FIELD VERIFICATION:
The Contractor shall verify all figured dimensions and conditions at the project site and notify Zebra Architecture, PLLC of any dimensional errors, omissions or discrepancies before beginning or fabricating any work. Do not scale these drawings.
Copyright © 2024
Zebra Architecture, PLLC shall retain all common law, statutory and all other reserved rights. Neither the documents nor the information herein is to be reproduced, distributed, disclosed or otherwise without the written consent of Zebra Architecture, PLLC.

CONSULTANT:

Designer's Information:

Kimley»Horn
445 24TH STREET, SUITE 200, VERO BEACH, FL 32960
PHONE: 772-794-4100
WWW.KIMLEYHORN.COM
© 2024 KIMLEY-HORN AND ASSOCIATES, INC.

KIMLEY HORN Project Manager: KB

Raising Cane's
PROTOTYPE P4E-AV
SCHEME A of B
VERSION 2024-1.0

RAISING CANE'S
RESTAURANT NO.: #1307
14025 BISCAYNE BLVD.
(BISCAYNE BLVD & 143RD ST)
MIAMI, FLORIDA 33154

REV	DATE	DESCRIPTION
#	10.01.24	PRELIMINARY PHOTO DEVELOPMENT
XX	XX	

DRAWN BY: BPT
CHECKED BY: KEB
ARCH. PROJECT NO.: 147793039
SHEET NAME: TREE INVENTORY PLAN
SHEET NUMBER: L0.1

SITE PLAN REVIEW

Plotted By: Tuggle, Benj Sheet Set: C1307 BISCAYNE & NE 140TH Layout: L2.0 LANDSCAPE PLAN February 10, 2025 05:24:28pm K:\VRB\DEV\Raising Canes\C1307 - Biscayne & NE 140th - North Miami Beach, FL\CAD\PlanSheets\L2-DSP.dwg

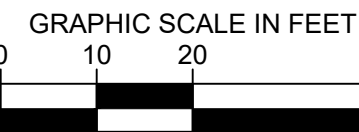
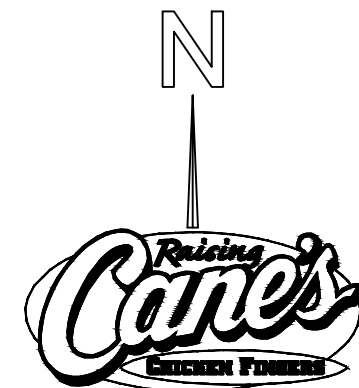
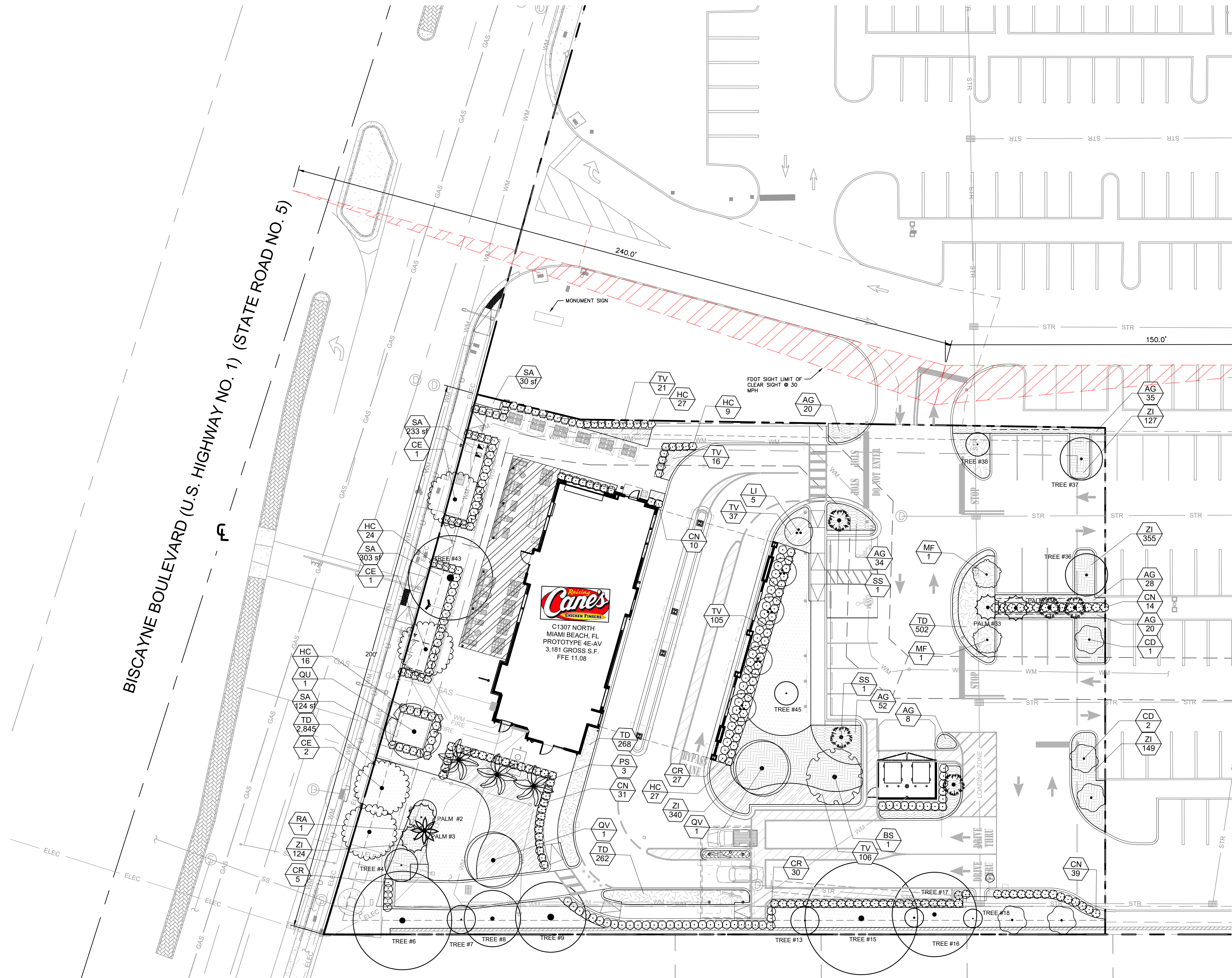

PLANT KEY

SYMBOL	CODE	COMMON NAME	BOTANICAL NAME
TREES			
	BS	GUMBO LIMBO	BURSERA SIMARUBA
	CD	PIGEON PLUM	COCCOLOBA DIVERSIFOLIA
	LI	CRAPE MYRTLE	LAGERSTROEMIA INDICA
	MF	SIMPSON'S STOPPER	MYRCIANTHES FRAGRANS
	QV	SOUTHERN LIVE OAK	QUERCUS VIRGINIANA
PALM TREES			
	PS	WILD DATE PALM	PHOENIX SYLVESTRIS
	SS	CABBAGE PALMETTO	SABAL PALMETTO
RELOCATED TREES			
	RA	RELOCATED ALEXANDER PALM	ARCHONTOPHOENIX ALEXANDREA
STREET TREES			
	CE	BUTTONWOOD	CONOCARPUS ERECTUS
	QU	SOUTHERN LIVE OAK	QUERCUS VIRGINIANA
SHRUBS			
	CR	RED TIP COCOPLUM	CHRYSOBALANUS ICACO 'RED TIP'
	CN	DWARF PITCH APPLE	CLUSIA ROSEA 'NANA'
	HC	DWARF FIREBUSH	HAMELIA PATENS 'COMPACTA'
GROUND COVERS			
	AG	PERENNIAL PEANUT	ARACHIS GLABRATA
	SA	FLORATAM ST. AUGUSTINE GRASS	STENOTAPHRUM SECUNDATUM 'FLORATAM'
	TV	VARIEGATED DWARF JASMINE	TRACHELOSPERMUM ASIATICUM 'VARIEGATA'
	TD	DWARF FAKAHATCHEE GRASS	TRIPSACUM DACTYLOIDES NANA
	ZI	COONTIE	ZAMIA INTEGRIFOLIA

*PLEASE REFER TO SHEET L2.1 FOR LANDSCAPE DATA TABLE AND PLANTING SCHEDULE.

PLANTING NOTES:

- CONTRACTOR SHALL REFER TO THE LANDSCAPE PLANTING DETAILS, PLANT LIST, GENERAL NOTES AND ALL CONTRACT DOCUMENTS FOR FURTHER AND COMPLETE INSTRUCTIONS.
- PLANT LIST QUANTITIES ARE PROVIDED FOR CONVENIENCE. IN THE EVENT OF QUANTITY DISCREPANCIES THE DRAWING SHALL TAKE PRECEDENCE. ANY DISCREPANCIES SHALL BE BROUGHT TO THE ATTENTION OF THE LANDSCAPE ARCHITECT PRIOR TO BIDDING.
- PLANT SIZES LISTED ARE THE MINIMUM SIZE THAT WILL BE ACCEPTED FOR THAT PLANT.
- ANY SUBSTITUTION IN SIZE AND/OR PLANT MATERIAL MUST BE APPROVED BY THE LANDSCAPE ARCHITECT IN WRITING. ALL PLANTS WILL BE SUBJECT TO APPROVAL BY LANDSCAPE ARCHITECT AND/OR OWNERS REPRESENTATIVE BEFORE PLANTING CAN BEGIN.
- CONTRACTOR SHALL FIELD ADJUST LOCATION OF PLANT MATERIAL AS NECESSARY TO AVOID DAMAGE TO EXISTING UNDERGROUND UTILITIES AND/OR INTERFERE WITH EXISTING ABOVE GROUND ELEMENTS. ALL CHANGES REQUIRED SHALL BE COMPLETED AT THE CONTRACTOR'S EXPENSE AND SHALL BE COORDINATED WITH THE OWNER'S REPRESENTATIVE AND THE LANDSCAPE ARCHITECT.
- THE CONTRACTOR SHALL BEAR ALL COSTS OF TESTING OF SOILS, AMENDMENTS, ETC. ASSOCIATED WITH THE WORK AND INCLUDED IN THE SPECIFICATIONS.
- CONTRACTOR SHALL FAMILIARIZE HIM/HERSELF WITH THE LIMITS OF WORK AND EXISTING CONDITIONS AND VERIFY ALL INFORMATION. IF DISCREPANCIES EXIST, CONTRACTOR SHALL NOTIFY OWNER'S REPRESENTATIVE IN WRITING WITHIN SEVEN CALENDAR DAYS OF NOTICE TO PROCEED.
- ALL NEW AND TRANSPLANTED PLANT MATERIAL SHALL BE IRRIGATED BY AN AUTOMATIC UNDERGROUND IRRIGATION SYSTEM. IRRIGATION DESIGN TO BE SUBMITTED AT THE TIME OF CONSTRUCTION PLANS.
- LANDSCAPE CONTRACTOR SHALL NOTIFY SUNSHINE ONE CALL OF FLORIDA, INC. AT 1-800-432-4770 A MINIMUM OF TWO FULL BUSINESS DAYS PRIOR TO DIGGING. LANDSCAPE CONTRACTOR IS RESPONSIBLE FOR AVOIDING DAMAGE TO UTILITIES FROM PLANT INSTALLATION.
- ALL PLANTING MUST FOLLOW PLANTING SPECIFICATIONS AND DETAILS SHOWN ON THE PLAN.
- SUBSTITUTIONS OF PLANT SPECIES OR SPECIFICATIONS MUST BE APPROVED IN WRITING BY LANDSCAPE ARCHITECT AND VENICE, FL PRIOR TO USE.
- ALL PLANT MATERIAL PLANTED PER THIS LANDSCAPE PLAN SHALL BE FLORIDA GRADE #1 OR BETTER, AS SPECIFIED IN THE CURRENT EDITION OF THE FLORIDA DEPARTMENT OF AGRICULTURE'S GRADE AND STANDARDS FOR NURSERY PLANTS. DAMAGED PLANT MATERIAL SHALL BE REJECTED AND REPLACED PRIOR TO INSTALLATION.
- ALL SIZES SHOWN FOR PLANT MATERIAL ARE TO BE CONSIDERED MINIMUMS.
- ALL NEW PLANT MATERIAL SHALL BE WARRANTED FOR A MINIMUM PERIOD OF ONE YEAR. THE WARRANTY PERIOD SHALL BEGIN AFTER ACCEPTANCE OF THE PLANTS BY THE CITY LANDSCAPE INSPECTOR.
- ALL PLANT MATERIAL SHALL BE IN ACCORDANCE WITH THE CITY FOR MINIMAL MATERIAL SIZES, COVERAGE, AND QUALITY.
- PLANT BEDS TO BE TREATED WITH PRE-EMERGENT HERBICIDE PRIOR TO PLANTING.
- ALL TREE AND PALM STAKING AND SUPPORTS SHALL BE REMOVED ONE YEAR AFTER INSTALLATION.
- NO FERTILIZER SHALL BE APPLIED TO NEWLY PLANTED TREES AND PALMS.
- ALL LANDSCAPE MATERIAL SHALL BE THOROUGHLY WATERED AT THE TIME OF PLANTING, NO DRY PLANTING PERMITTED.
- LANDSCAPE CONTRACTOR SHALL BE RESPONSIBLE FOR PROVIDING TEMPORARY WATER PROVISIONS UNTIL SUCH TIME AS THE IRRIGATION SYSTEM IS OPERATIONAL.
- ALL WIRE GUYS AND/OR FABRIC SHALL BE FLAGGED WITH FLORESCENT COLORED TAPE.
- MULCHING:
 - ALL LANDSCAPE AREAS NOT COVERED BY SOD SHALL BE COVERED BY A MINIMUM 3-INCH LAYER OF MULCH.
 - A MULCH RING WITH A MINIMUM RADIUS OF 24 INCHES (48 INCH DIAMETER), IS REQUIRED AROUND NEWLY INSTALLED TREES AND PALMS.
 - CYPRESS MULCH SHALL NOT BE USED.
 - NO MULCH SHALL BE PLACED TOUCHING OR WITHIN SIX INCHES OF THE TRUNK OF A TREE OR PALM. TREE KILLS OR DAMAGE RESULTING FROM IMPROPER PLACEMENT OF MULCH SHALL BE REMEDIATED AT THE CONTRACTOR'S SOLE COST, AND EXPENSE
- LANDSCAPE TO BE 100% IRRIGATED UPON INSTALLATION.

BENCHMARKS

ELEVATIONS ARE BASED ON NORTH GEODETIC VERTICAL DATUM OF 1929. MIAMI-DADE COUNTY BENCHMARK: S-35; ELEVATION: 11.33 FEET.

DEWATERING NOTE

THE GENERAL CONTRACTOR IS TO DEWATER THE SITE BASED ON THEIR MEANS AND METHODS FOR INSTALLATION OF UTILITIES AND UNDERGROUND WORK. ALL COSTS ASSOCIATED WITH DEWATERING SHALL BE INCLUDED IN THE BID.



ZEBRA ARCHITECTURE, PLLC
14614 N KIERLAND BLVD, SUITE
N300
SCOTTSDALE, ARIZONA 85254
PHONE: 480.912.1169 zbr.glob@zebraarch.com

PRELIMINARY:
Preliminary Documents are for design review only and not intended for bidding, negotiating, permitting, or construction purposes. They were prepared by or under the supervision of Zebra Architecture PLLC, Inc.

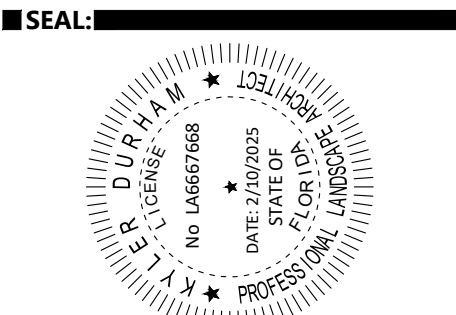

FIELD VERIFICATION:
The Contractor shall verify all figured dimensions and conditions at the project site and notify Zebra Architecture, PLLC of any dimensional errors, omissions or discrepancies before beginning or fabricating any work. Do not scale these drawings.
COPYRIGHT © 2024
Zebra Architecture, PLLC shall retain all common law, statutory and all other reserved rights. Neither the documents nor the information herein is to be reproduced, distributed, disclosed or otherwise without the written consent of Zebra Architecture, PLLC.

CONSULTANT:
Designer's Information:



445 24TH STREET, SUITE 200, VERO BEACH, FL 32960
PHONE: 772-794-4100
WWW.KIMLEY-HORN.COM
© 2024 KIMLEY-HORN AND ASSOCIATES, INC.

KIMLEY HORN Project Manager: KB



RAISING CANE'S
RESTAURANT NO.: #1307
14025 BISCAYNE BLVD.
(BISCAYNE BLVD & 143RD ST)
MIAMI, FLORIDA 33154

REV	DATE	DESCRIPTION
1	10.01.24	PRELIMINARY PRTO DEVELOPMENT
2	XX	XX

DRAWN BY: BPT
CHECKED BY: KEB
ARCH. PROJECT NO.: 147793039
SHEET NAME: LANDSCAPE PLAN

SHEET NUMBER: L2.0

SITE PLAN REVIEW

Plotted By: Tuggle, Benj Sheet Set: C1307 BISCAYNE & NE 140TH Layout: L2.1 LANDSCAPE SCHEDULE AND CODE TABLE February 10, 2025 05:24:39pm K:\VRB_LDEV\Raising Cane\GIS\307 - Biscayne & NE 140th - North Miami Beach, FL\CAD\PlanSheets\L2-LD57.dwg

NORTH MIAMI BEACH LANDSCAPE LEGEND

Zoning District **MU-C** Net Lot Area: **1.053 Acres** or **45,854 SF**

OPEN SPACE

A. Square feet of open space, as indicated on site plan:
Net Lot area = **45,854**

	REQUIRED	PROVIDED
A.	- SF	13,190 SF

LAWN AREA CALCULATION

A. Total square feet of landscape open space = **13,190 SF**
B. Maximum lawn area permitted = **50%** x required landscape open space = **6,595 SF**

	REQUIRED	PROVIDED
A.	13,190 SF	
B.	6,595 SF	4,884 SF

Note: Very dry tolerant grasses and low growing native plants, including grasses and forbs, as referenced in the Landscape Manual, may be used as groundcover beyond the maximum permitted grass area specified.

TREES

A. Total trees provided on site = **28 trees**
B. 25% palm trees allowed (three palms = one tree) = **12 trees**

	REQUIRED	PROVIDED
A.	28 trees	28 trees + 20 exist
B.	12 trees	8 trees + 4 exist

D. Street trees (max. average spacing of 30' O.C.):
200 linear feet along street / 30 = **7 trees**

	REQUIRED	PROVIDED
D.	7 trees	5 trees + (2 exist)

E. Perimeter Trees (max. average spacing of 30' O.C.):
278 linear feet along street / 30 = **9 trees**
continuous hedge

	REQUIRED	PROVIDED
E.	9 trees	2 trees + (7 exist)
	3' cont. hedge	3' cont. hedge

F. 1 Tree/ Terminal Island = **9 Trees**
E. Medians: 1 Tree/25 LF = **2 Trees**

	REQUIRED	PROVIDED
F.	9 Trees	6 Trees + 3 exist
E.	2 Trees	2 Trees + 2 exist

PLANT SCHEDULE

SYMBOL	CODE	QTY	COMMON NAME	BOTANICAL NAME	CONTAINER	CAL	HT	NATIVE
TREES								
	BS	1	GUMBO LIMBO GRADE NO. 1, UNIFORM TRUNK, STANDARD	BURSERA SIMARUBA	F.G.	3" DBH MIN.	12' HT MIN. X 5' SPR	YES
	CD	5	PIGEON PLUM 8" CLEAR TRUNK MIN., GRADE NO. 1, UNIFORM TRUNK, STANDARD	COCCOLOBA DIVERSIFOLIA	F.G.	3" DBH MIN.	12' HT MIN. X 5' SPR	YES
	LI	5	GRAPE MYRTLE GRADE NO. 1, STANDARD, MULTI-TRUNK	LAGERSTROEMIA INDICA	F.G.	3" DBH TOTAL, MULTI-STEM	12' HT MIN. X 5' SPR	YES
	MF	2	SIMPSON'S STOPPER GRADE NO. 1, UNIFORM TRUNK, STANDARD	MYRCIANTHES FRAGRANS	F.G.	3" DBH MIN.	12' HT MIN. X 5' SPR	YES
	QV	2	SOUTHERN LIVE OAK GRADE NO. 1, UNIFORM TRUNK, STANDARD	QUERCUS VIRGINIANA	F.G.	3" DBH MIN.	12' HT MIN. X 5' SPR	YES
PALM TREES								
	PS	3	WILD DATE PALM GRADE NO. 1, UNIFORM TRUNK, HEAVY	PHOENIX SYLVESTRIS	F.G.		10' HT MIN.	NO
	SS	5	CABBAGE PALMETTO GRADE NO. 1, UNIFORM TRUNK	SABAL PALMETTO	F.G.		10' HT MIN.	YES
RELOCATED TREES								
	RA	1	RELOCATED ALEXANDER PALM	ARCHONTOPHOENIX ALEXANDREA	F.G.			
STREET TREES								
	CE	4	BUTTONWOOD GRADE NO. 1, UNIFORM TRUNK, STANDARD	CONOCARPUS ERECTUS	F.G.	3" DBH MIN.	12' HT MIN. X 5' SPR	YES
	QU	1	SOUTHERN LIVE OAK GRADE NO. 1, UNIFORM TRUNK, STANDARD	QUERCUS VIRGINIANA	F.G.	3" DBH MIN.	12' HT MIN. X 5' SPR	YES
SYMBOL	CODE	QTY	COMMON NAME	BOTANICAL NAME	CONT	SPACING	SIZE	NATIVE
SHRUBS								
	CR	77	RED TIP COCOPLUM FULL TO BOTTOM OF CONTAINER	CHRYSOBALANUS ICACO 'RED TIP'	CONT.	18" O.C.	36" HT MIN., 24" SPR MIN.	YES
	CN	94	DWARF PITCH APPLE FULL TO BOTTOM OF CONTAINER	CLUSIA ROSEA 'NANA'	CONT.	18" O.C.	24" HT. MIN., 24" SPR MIN.	NO
	HC	124	DWARF FIREBUSH FULL TO BOTTOM OF CONTAINER	HAMELIA PATENS 'COMPACTA'	CONT.	18" O.C.	18" HT MIN., 18" SPR MIN.	NO
SYMBOL	CODE	QTY	COMMON NAME	BOTANICAL NAME	CONT	O.C.	SIZE	NATIVE
GROUND COVERS								
	AG	236	PERENNIAL PEANUT FULL IN CONTAINER, SPECIFICATIONS TO BE MET AT MINIMUM	ARACHIS GLABRATA	CONT.	24" O.C.	6 IN MIN	YES
	SA	4,884 SF	FLORATAM ST. AUGUSTINE GRASS TIGHTLY ROLLED, BUG-FREE	STENOTAPHRUM SECUNDATUM 'FLORATAM'	SOD			
	TV	450	VARIEGATED DWARF JASMINE FULL TO TOP OF CONTAINER	TRACHELOSPERMUM ASIATICUM 'VARIEGATA'	CONT.	24" O.C.	6" HT MIN. X 12" SPR MIN.	NO
	TD	1,091	DWARF FAKAHATCHEE GRASS FULL TO TOP OF CONTAINER	TRIPSACUM DACTYLOIDES NANA	CONT.	12" O.C.	6" HT MIN. X 12" SPR MIN.	YES
	ZI	788	COONTIE FULL TO TOP OF CONTAINER	ZAMIA INTEGRIFOLIA	CONT.	18" O.C.	6" HT MIN. X 12" SPR MIN.	YES
			TREE TO REMAIN					
			PALM TO REMAIN					

BENCHMARKS

ELEVATIONS ARE BASED ON NORTH GEODETIC VERTICAL DATUM OF 1929.
MIAMI-DADE COUNTY BENCHMARK: S-35; ELEVATION: 11.33 FEET.

DEWATERING NOTE
THE GENERAL CONTRACTOR IS TO DEWATER THE SITE BASED ON THEIR MEANS AND METHODS FOR INSTALLATION OF UTILITIES AND UNDERGROUND WORK. ALL COSTS ASSOCIATED WITH DEWATERING SHALL BE INCLUDED IN THE BID.



Know what's below.
Call before you dig.

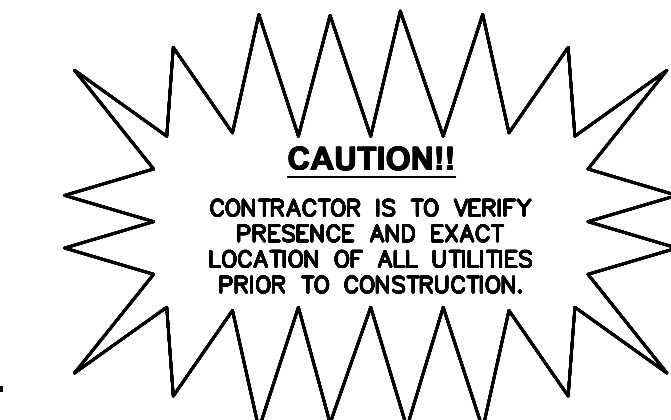

zebra
ZEBRA ARCHITECTURE, PLLC
14614 N KIERLAND BLVD, SUITE
N300
SCOTTSDALE, ARIZONA 85254
PHONE: 480.912.1169 zbr.glob@zebraarch.com

PRELIMINARY:
Preliminary Documents are for design review only and not intended for bidding, negotiating, permitting, or construction purposes. They were prepared by or under the supervision of Zebra Architecture PLLC, Inc.

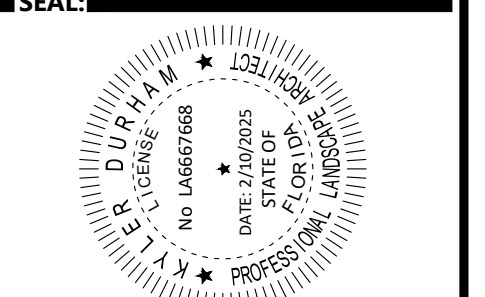

FIELD VERIFICATION:
The Contractor shall verify all figured dimensions and conditions at the project site and notify Zebra Architecture, PLLC, of any dimensional errors, omissions or discrepancies before beginning or fabricating any work. Do not scale these drawings.

CONSULTANT:
Zebra Architecture, PLLC shall retain all common law, statutory and all other reserved rights. Neither the documents nor the information herein is to be reproduced, distributed, disclosed or otherwise without the written consent of Zebra Architecture, PLLC.

Designer's Information:

Kimley»Horn
445 24TH STREET, SUITE 200, VERO BEACH, FL 32960
PHONE: 772-794-4100
WWW.KIMLEY-HORN.COM
© 2024 KIMLEY-HORN AND ASSOCIATES, INC.

KIMLEY HORN Project Manager: KB

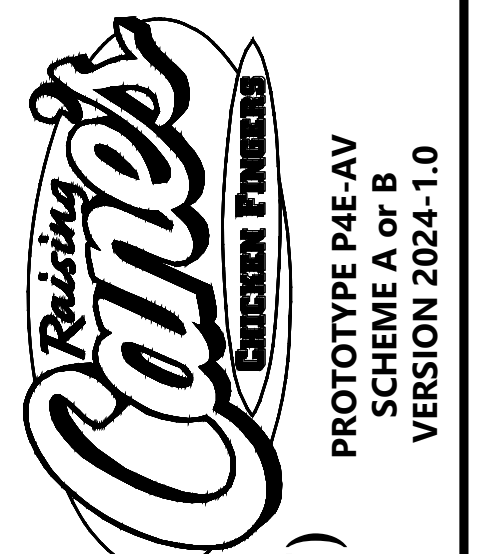

RAISING CANE'S
RESTAURANT NO.: #1307
14025 BISCAYNE BLVD.
(BISCAYNE BLVD & 143RD ST)
MIAMI, FLORIDA 33154

REV	DATE	DESCRIPTION
#	10.01.24	PRELIMINARY PHOTO DEVELOPMENT
XX		XX

DRAWN BY: BPT
CHECKED BY: KEB
ARCH. PROJECT NO.: 147793039
SHEET NAME: LANDSCAPE SCHEDULE AND CODE TABLE
SHEET NUMBER: L2.1

SITE PLAN REVIEW

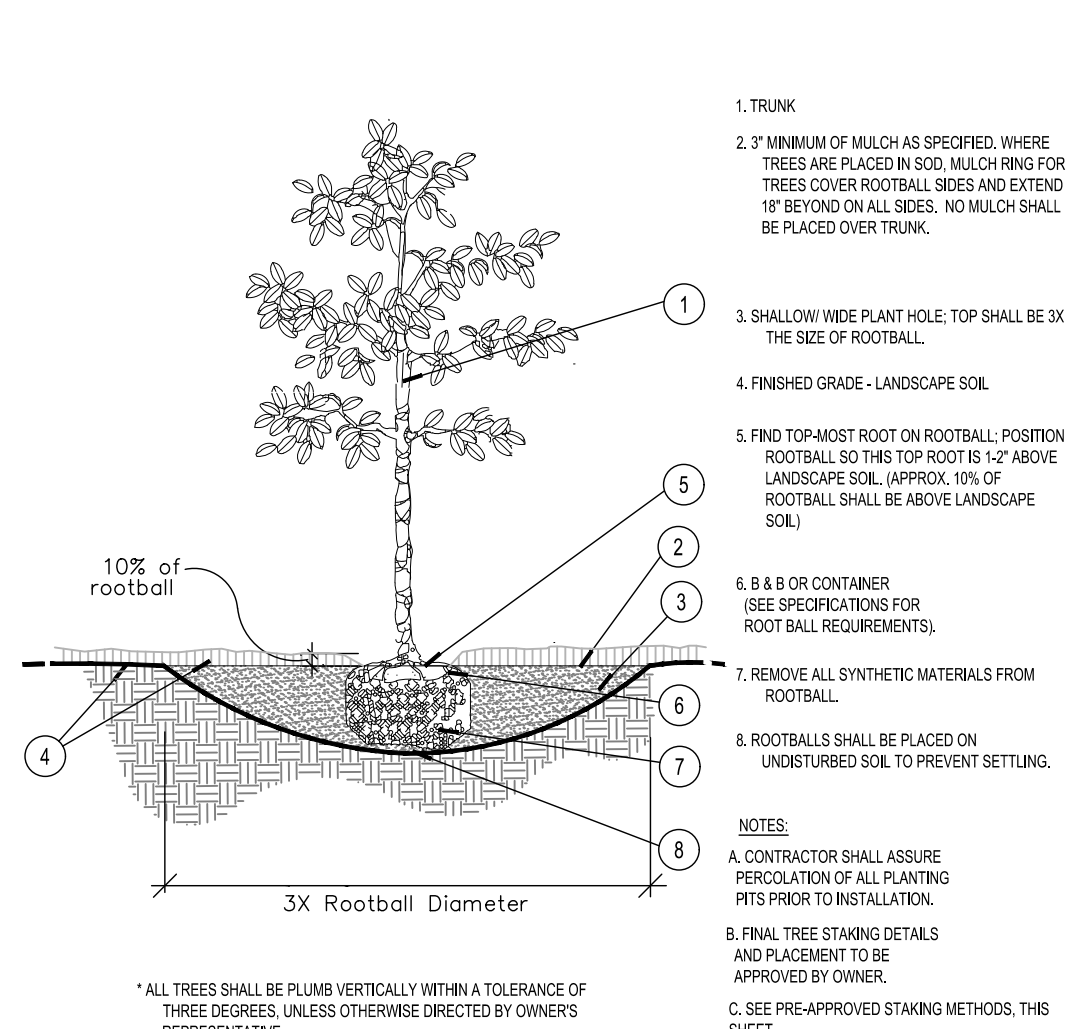

A Tree Planting

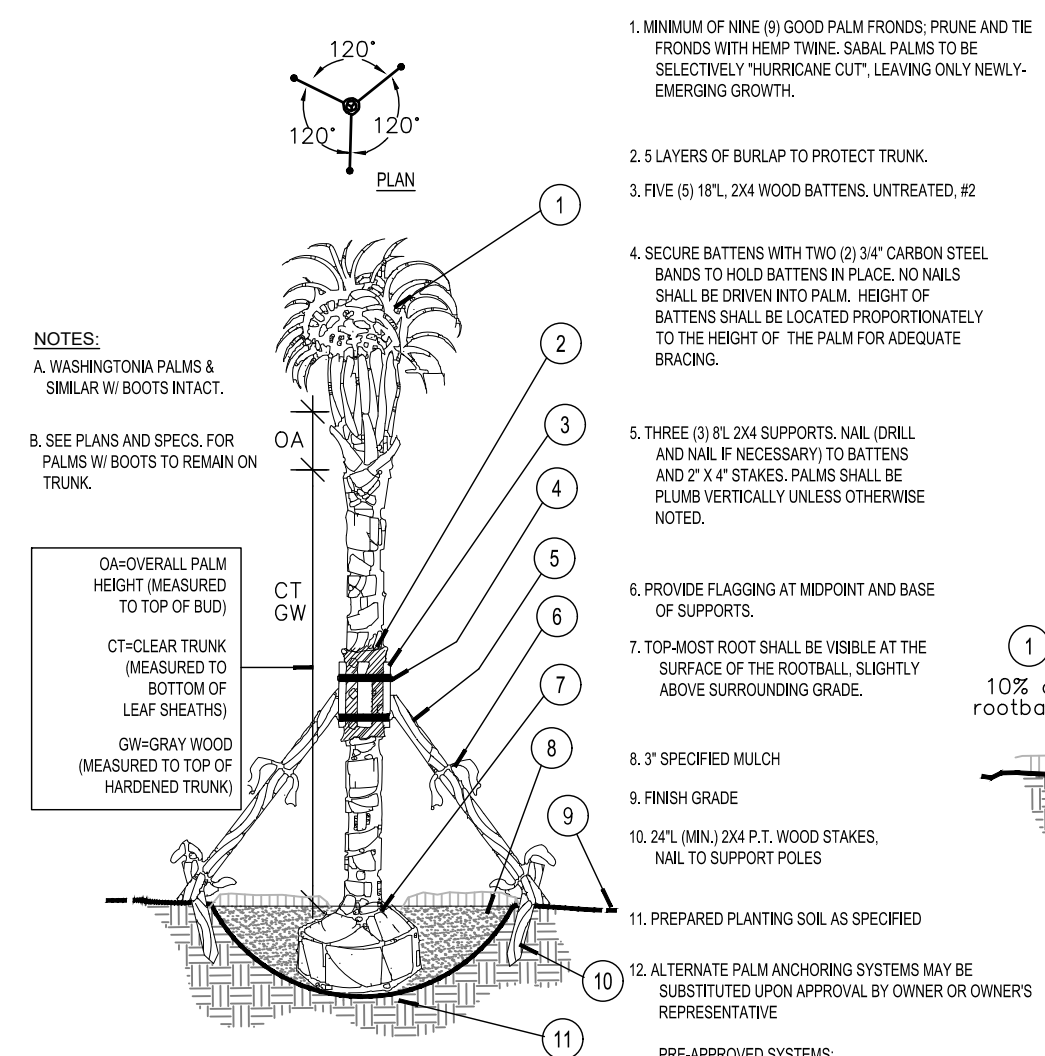

B Palm Planting and Staking

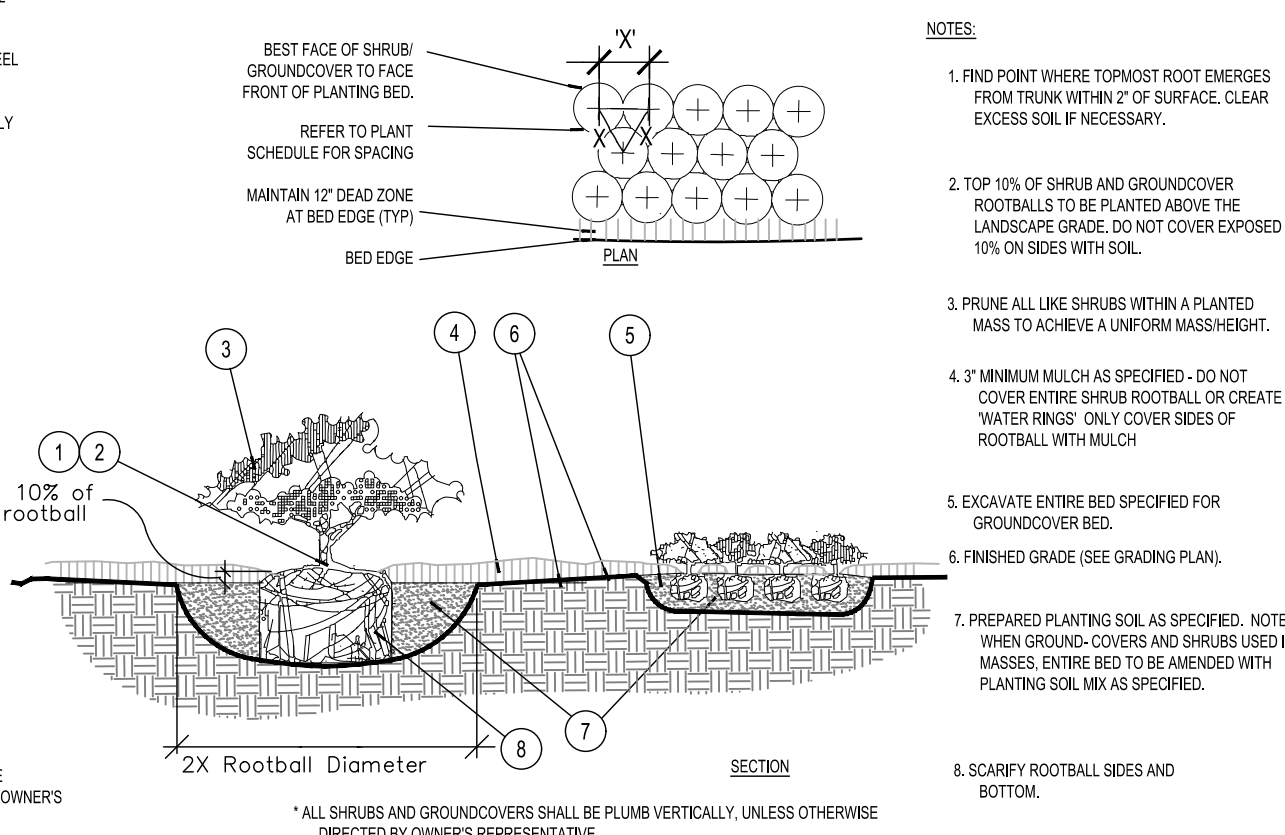

C Shrub / Groundcover Planting

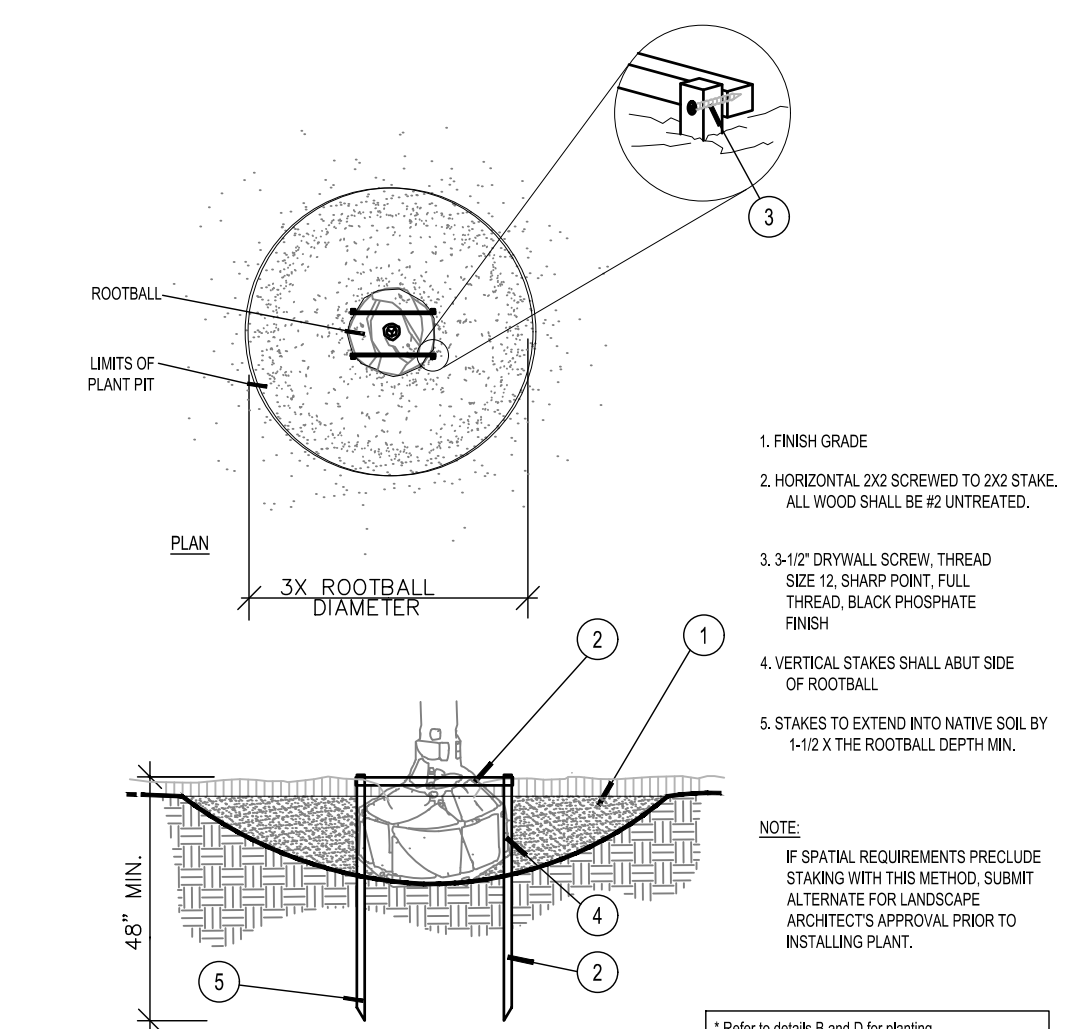

D Staking - up to 65 gal. or B&B to 3-1/2" Cal.

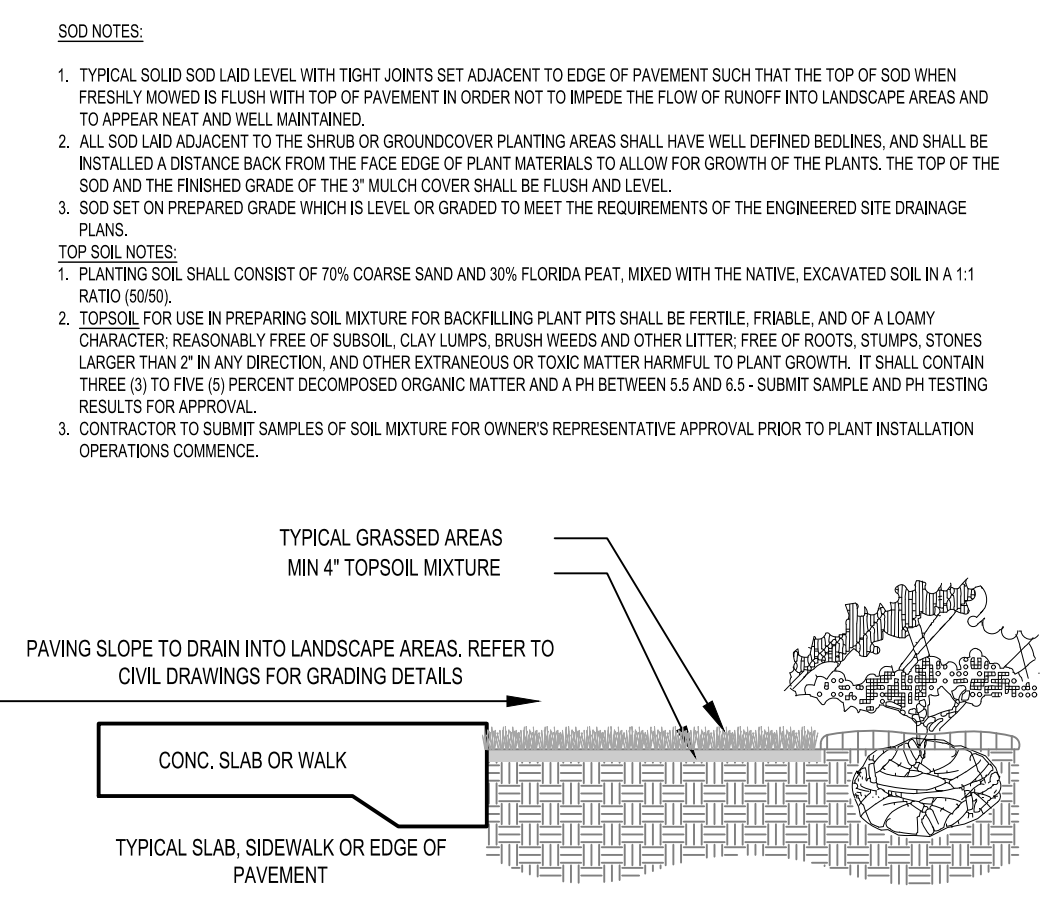

E SOD

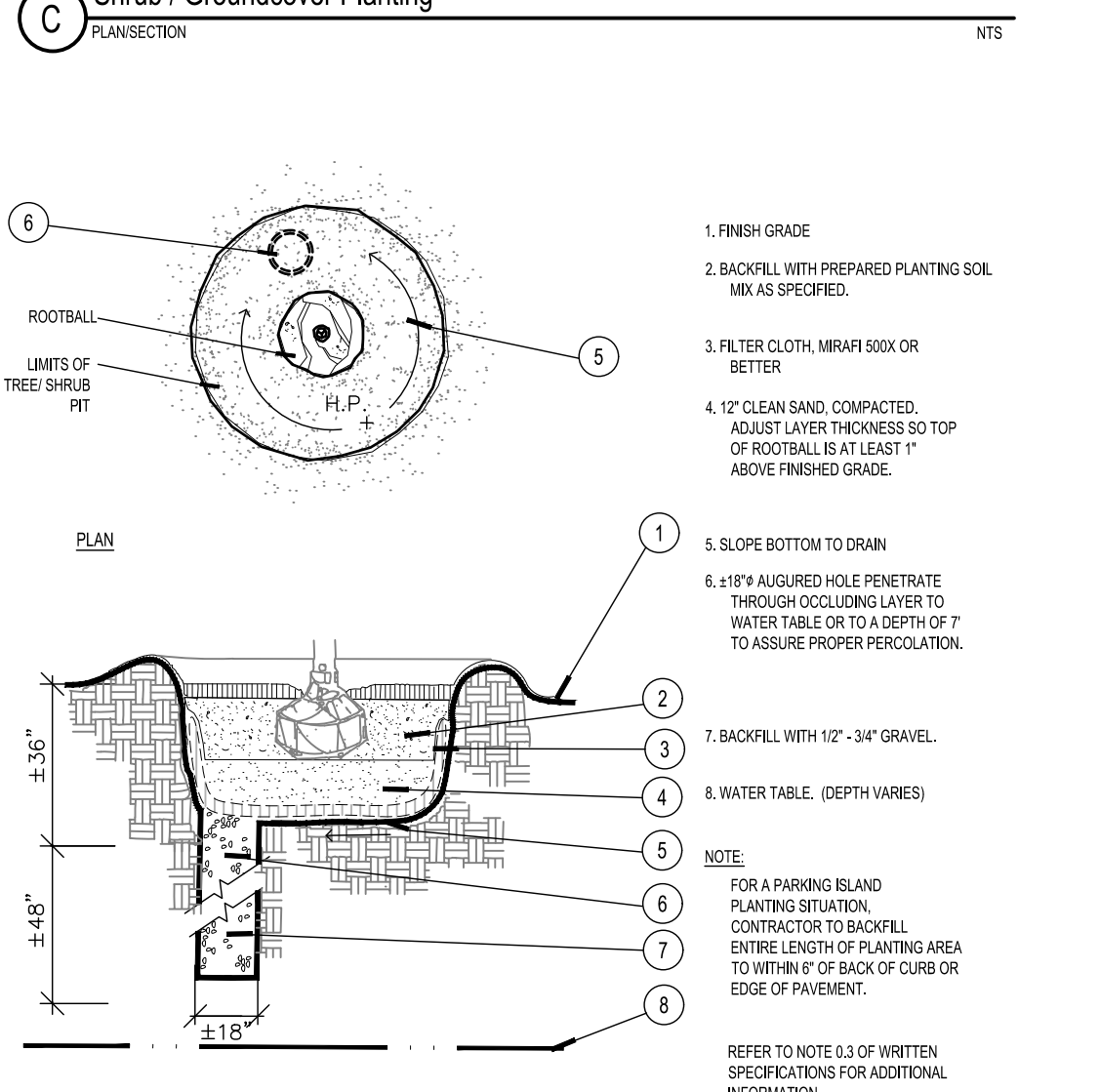

F Poor Drainage Condition

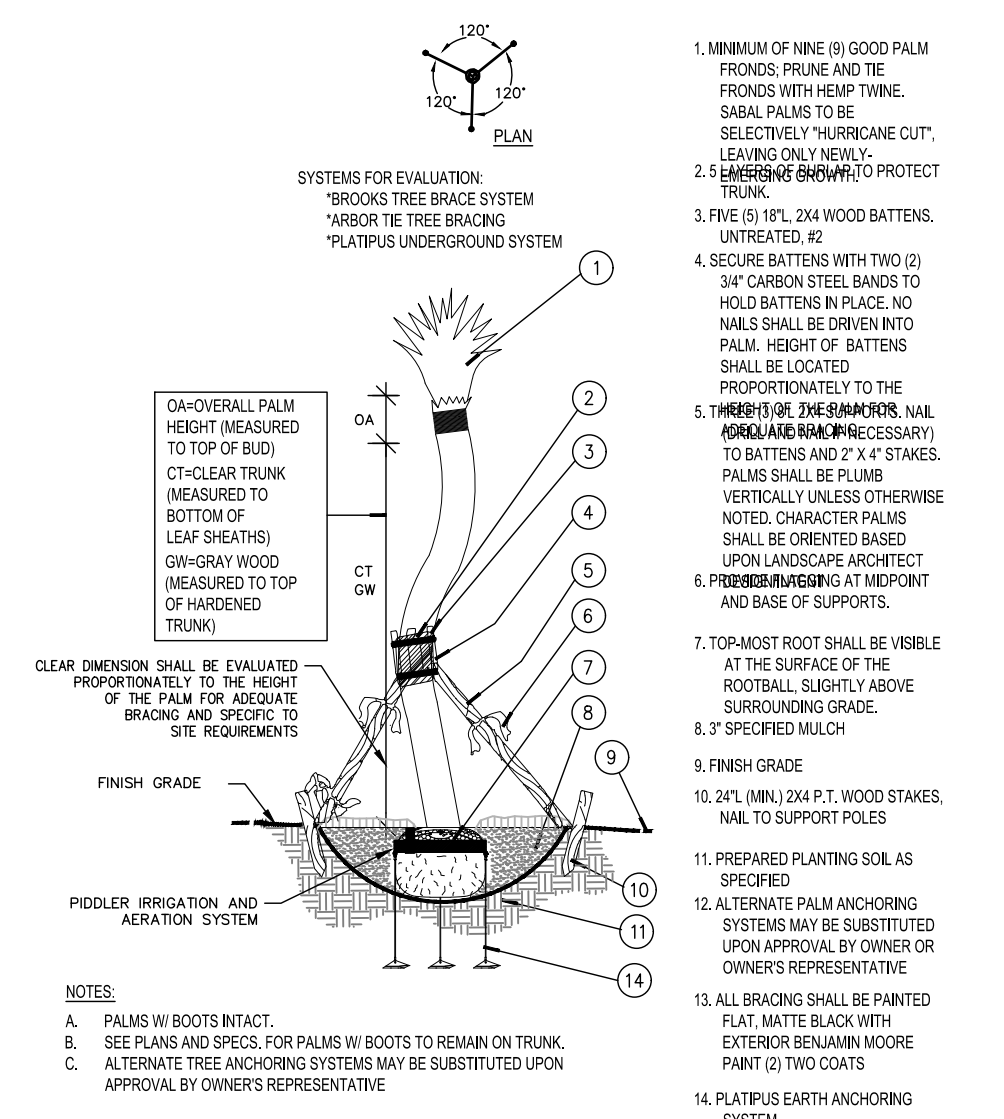

G CHARACTER PALM STAKING

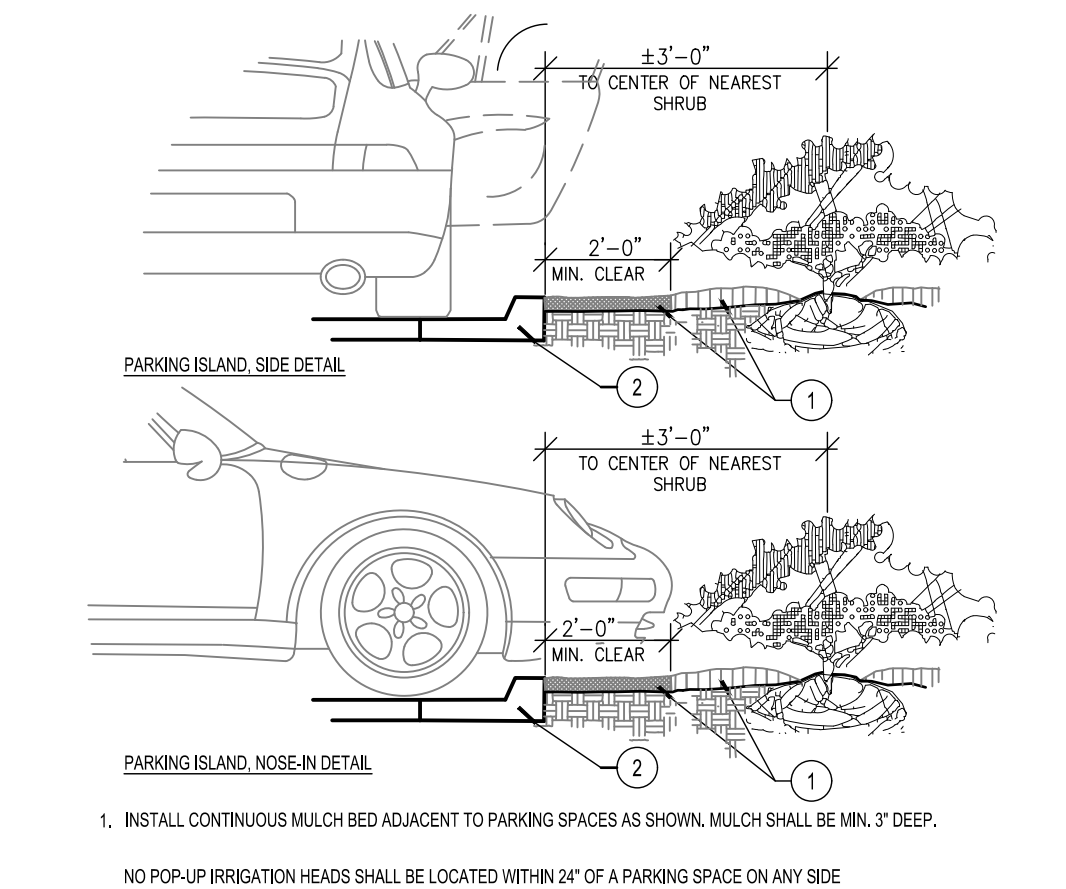

H Parking Space/Curb Planting

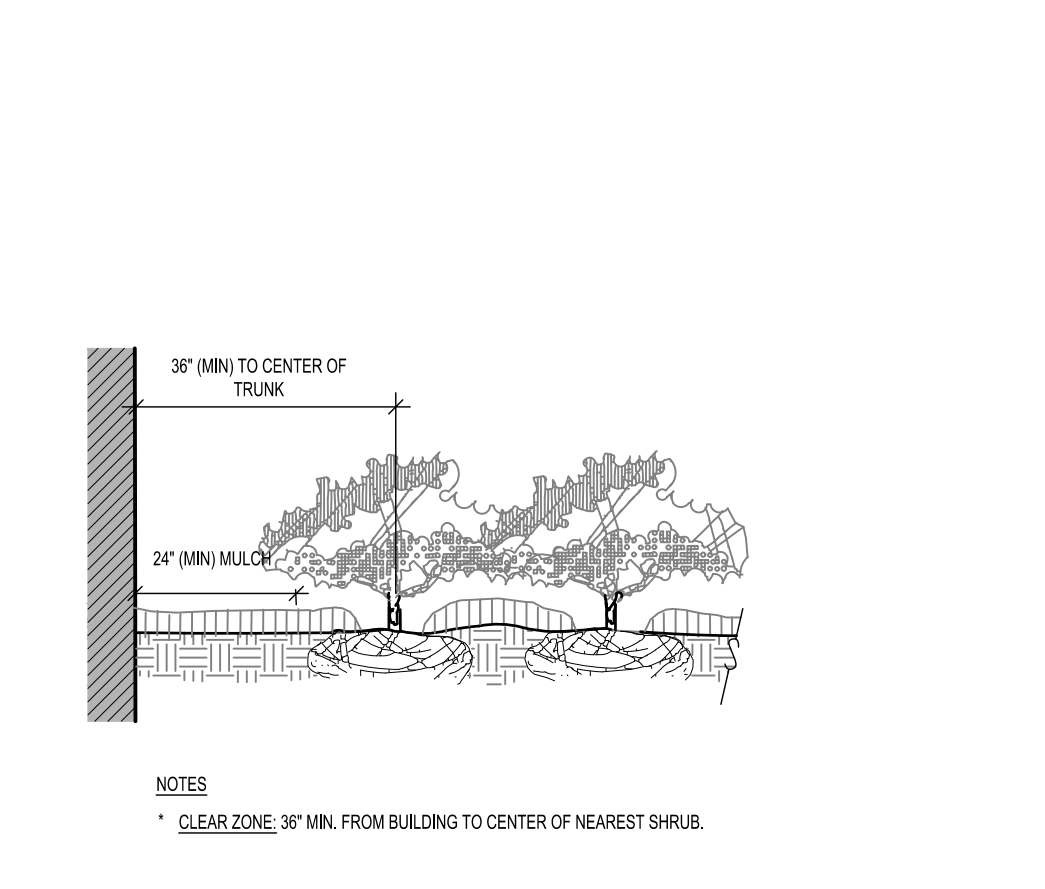

I Plantings Adjacent to Buildings

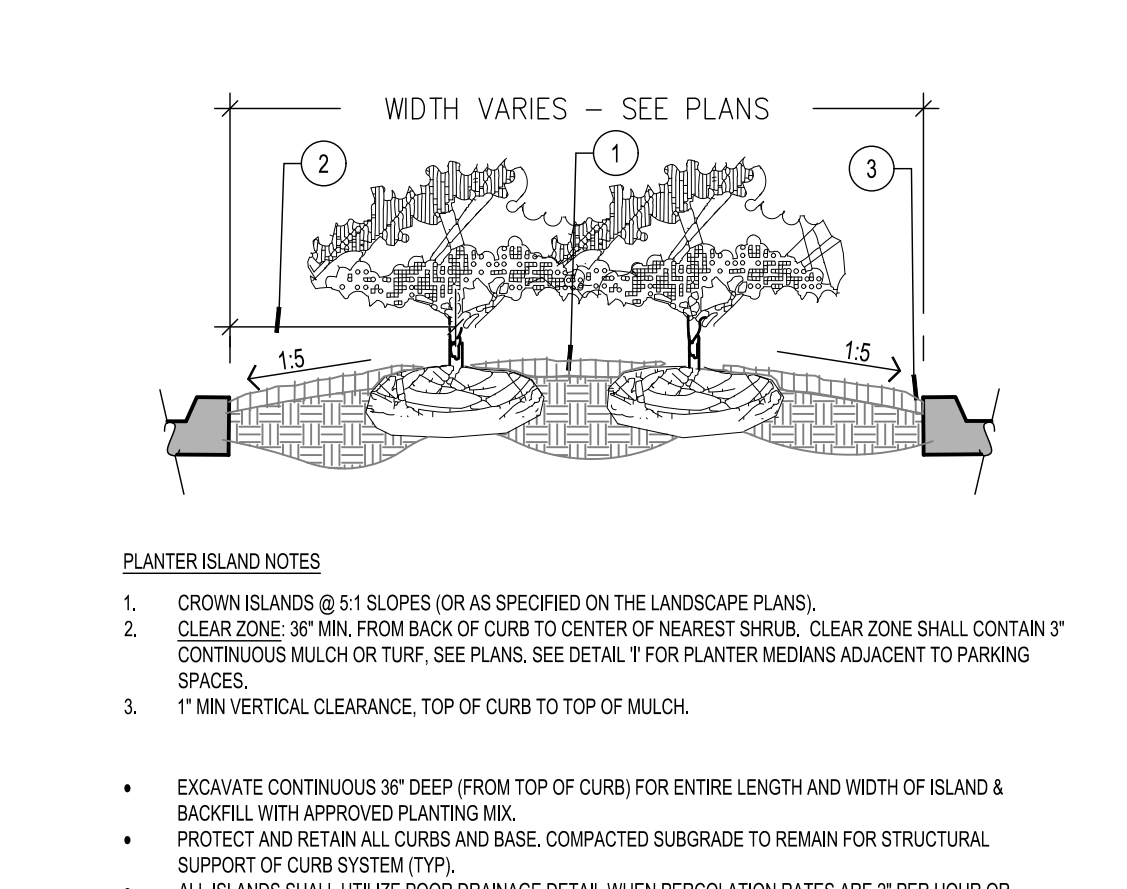

J Planted Parking Lot Islands / Medians

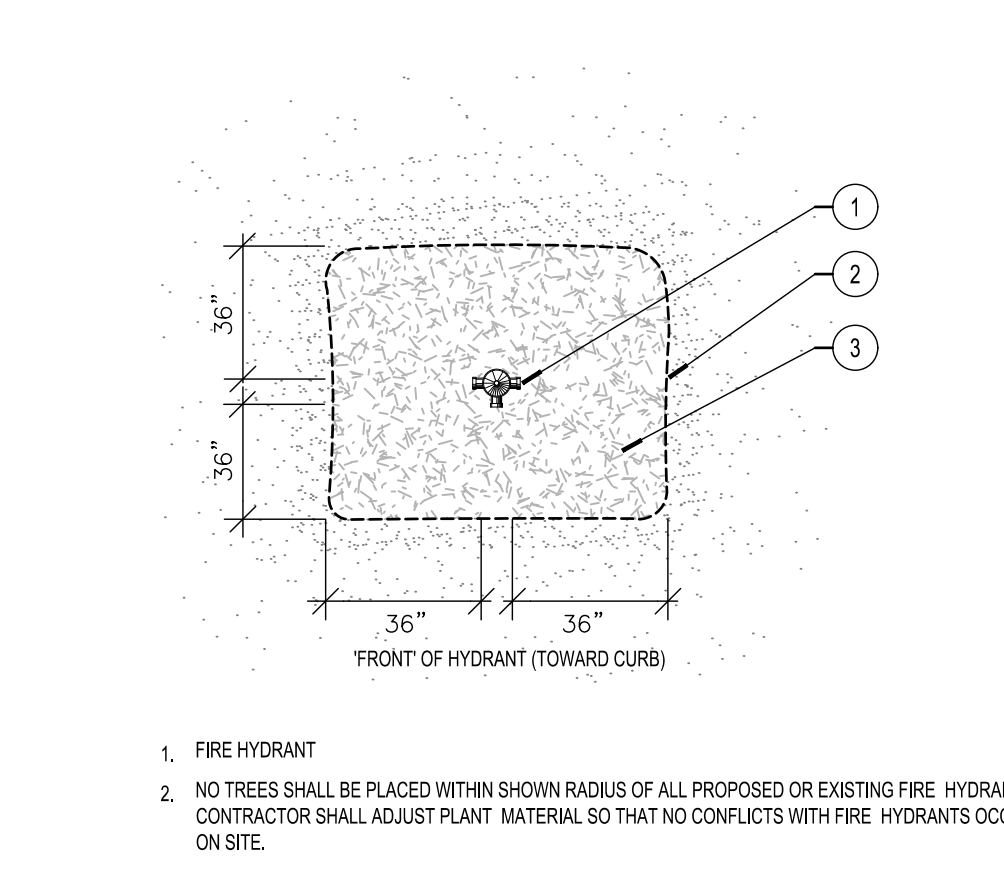

K Fire Hydrant Clear Zone

BENCHMARKS

ELEVATIONS ARE BASED ON NORTH GEODETIC VERTICAL DATUM OF 1929. MIAMI-DADE COUNTY BENCHMARK: S-35; ELEVATION: 11.33 FEET.

DEWATERING NOTE
THE GENERAL CONTRACTOR IS TO DEWATER THE SITE BASED ON THEIR MEANS AND METHODS FOR INSTALLATION OF UTILITIES AND UNDERGROUND WORK. ALL COSTS ASSOCIATED WITH DEWATERING SHALL BE INCLUDED IN THE BID.

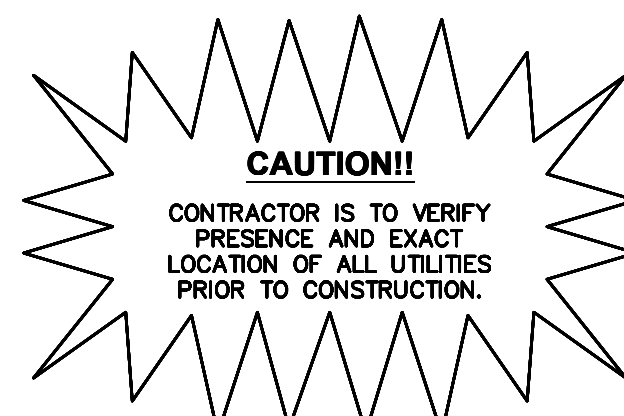

zebra
ZEBRA ARCHITECTURE, PLLC
14614 N KIERLAND BLVD, SUITE N300
SCOTTSDALE, ARIZONA 85254
PHONE: 480.912.1169 zbr.glob@zebraarch.com

PRELIMINARY:
Preliminary Documents are for design review only and not intended for bidding, negotiating, permitting, or construction purposes. They were prepared by or under the supervision of Zebra Architecture PLLC, Inc.

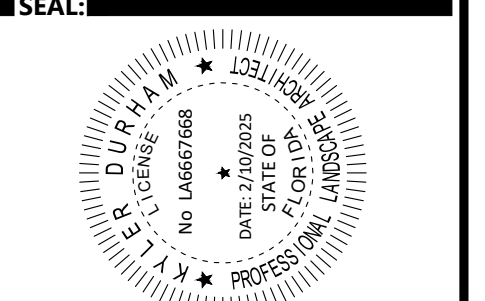

FIELD VERIFICATION:
The Contractor shall verify all figured dimensions and conditions at the project site and notify Zebra Architecture, PLLC, of any dimensional errors, omissions or discrepancies before beginning or fabricating any work. Do not scale these drawings.
COPYRIGHT © 2024 Zebra Architecture, PLLC. shall retain all common law, statutory and all other reserved rights. Neither the documents nor the information herein is to be reproduced, distributed, disclosed or otherwise without the written consent of Zebra Architecture, PLLC.

DESIGNER'S INFORMATION:
Kimley»Horn
445 24TH STREET, SUITE 200, VERO BEACH, FL 32960
PHONE: 772-794-4100
WWW.KIMLEY-HORN.COM
© 2024 KIMLEY-HORN AND ASSOCIATES, INC.

KIMLEY HORN Project Manager: KB

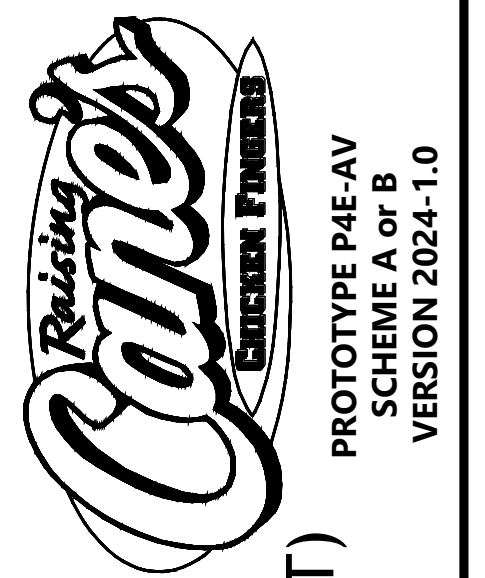

RAISING CANES'S
RESTAURANT NO.: #1307
14025 BISCAYNE BLVD.
(BISCAYNE BLVD & 143RD ST)
MIAMI, FLORIDA 33154

REV	DATE	DESCRIPTION
#	10.01.24	PRELIMINARY PRTO DEVELOPMENT
XX	XX	

DRAWN BY: BPT
CHECKED BY: KEB
ARCH. PROJECT NO.: 147793039
SHEET NAME: LANDSCAPE NOTES AND DETAILS
SHEET NUMBER: L2.3