

# NORTH MIAMI BEACH

1904 NE 167 ST North Miami Beach  
Folio # 07-2216-001-0150  
SECTION 16 TOWNSHIP 52S RANGE 42E

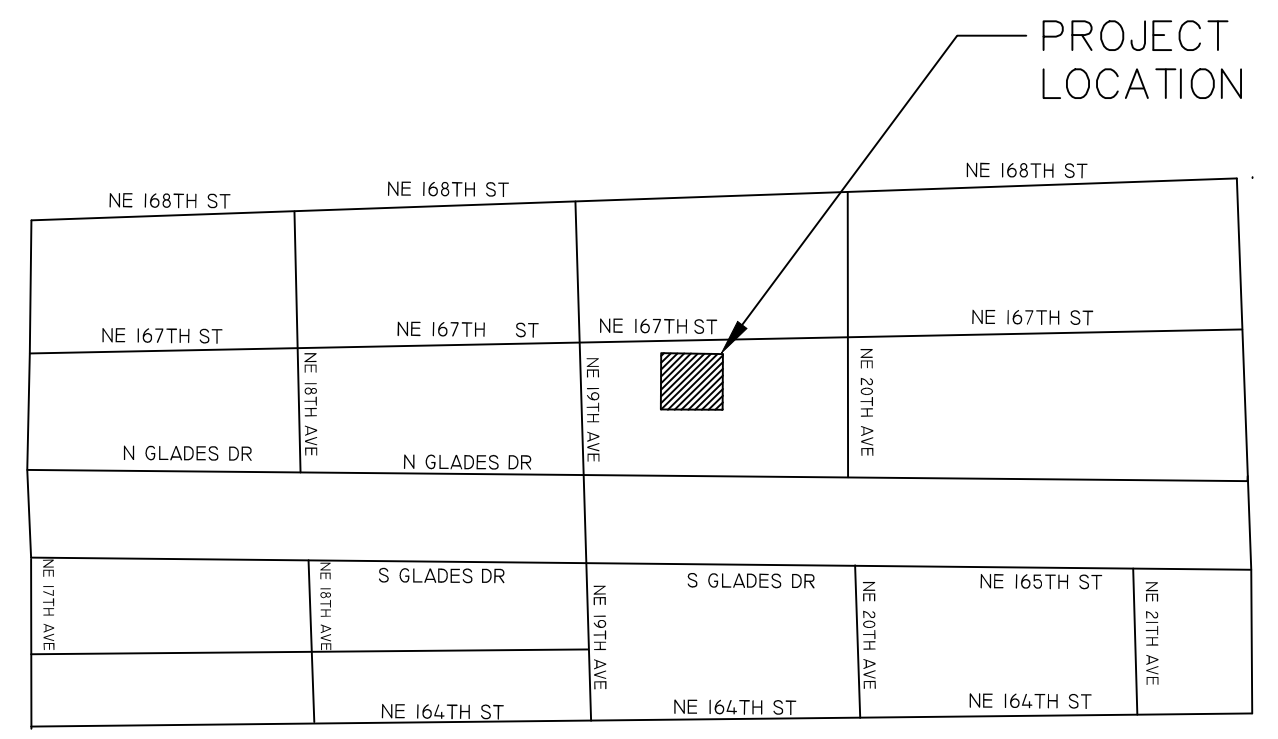

LOCATION MAP  
SCALE 1" = 300'

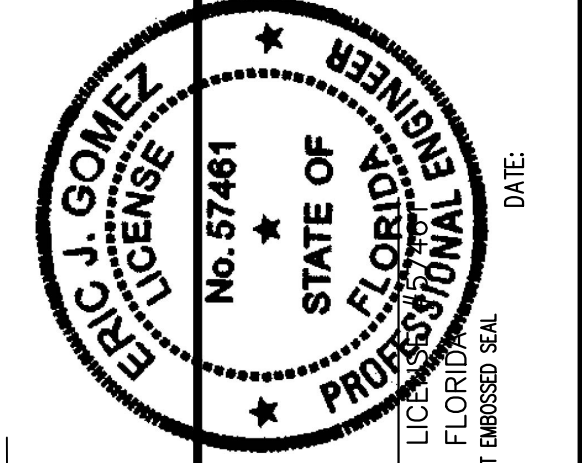

DESIGNED BY: EG  
DRAWN BY: WR  
CHECKED BY: EG  
SCALE: AS SHOWN



LEGAL DESCRIPTION  
Lots 3 and 4, Block 67, FULFORD BY THE SEA SECTION "F", according to the Plat thereof, as recorded in Plat Book 8, Page 64, of the Public Records of Miami-Dade County, Florida.

LEGEND			
EXISTING	PROPOSED	EXISTING	PROPOSED
PLAN ELEVATIONS		CHAIN LINK FENCE	
WATER CHECK VALVE		WOOD FENCE	
WATER METER		METAL FENCE	
CATCH BASIN (CB)		SANITARY SEWER	
GATE VALVE		WATER	
FIRE HYDRANT		STATIONING	STA. 3+00
MANHOLE SANITARY		CENTER LINE	
MANHOLE STORM SEWER		MONUMENT LINE	
MANHOLE TELEPHONE		BURIED TELEPHONE	
MANHOLE UNKNOWN		PROPERTY LINE	
MANHOLE ELECTRICAL		GAS LINE	

**811** KNOW WHAT'S BELOW ALWAYS CALL 811 BEFORE YOU DIG  
www.callsunshine.com

**DESIGN TICKET**  
287903571

DRAWING NAME: NORTH MIAMI BEACH  
PROJECT: 1904 NE 167 ST NORTH MIAMI BEACH  
PREPARED BY: EGSC ENGINEERING CONSULTANTS  
1701 NW 112th AVENUE #103 MIAMI, FL 33172  
TEL: 305.553.5457 EMAIL: egomez@egscfl.com

SHEET: **C-1** OF SHEETS